

**FIRE RESISTANT ACCESSORY FOR
GAS OUTLET TERMINATIONS**

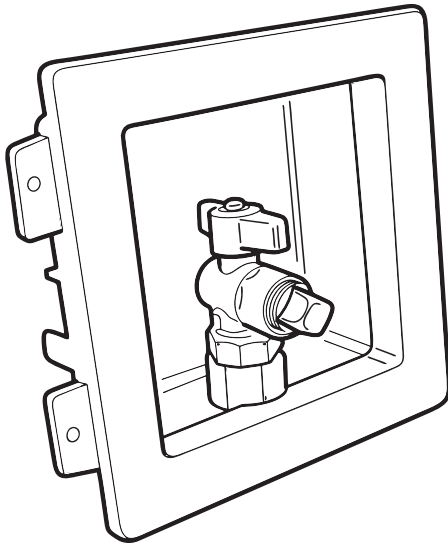

**Fire Rated Gas Outlet
Wall Box with Valve**
(FGP-WBTM-375 Shown)

All wallboxes measure 7" x 7" x 3"

Part Description	Part Number	Size	Pkg. Qty	Strip Length
Metal Wall Box with Valve	FGP-WBTM-375	3/8"	24 per box	1-1/2"
Metal Wall Box with Valve	FGP-WBTM-500	1/2"	24 per box	1-1/2"
Metal Wall Box with Valve	FGP-WBTM-750	3/4"	24 per box	1-3/4"

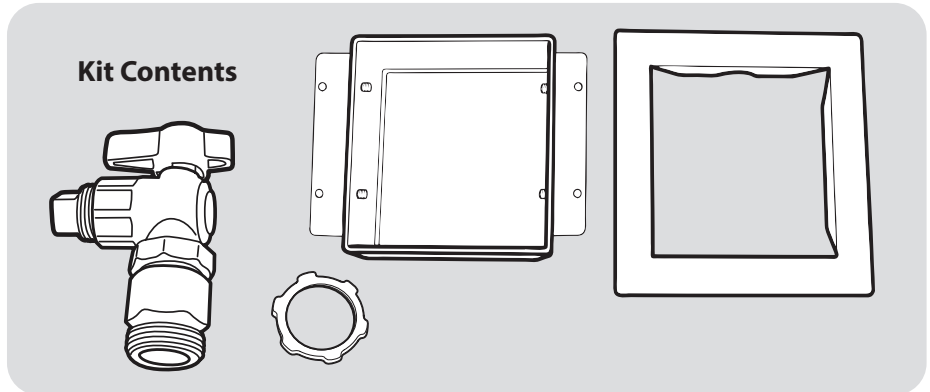

Kit Contents

PRODUCT DESCRIPTION:

The TracPipe®CounterStrike® Gas Outlet Wall Box has been tested and approved for 1 hr and 2 hr Fire Stop Systems in accordance with UL 1479.

The wall box installs with zero clearance for a finished appearance in laundry rooms, kitchens and mechanical rooms, and provides a rigid attachment point for appliance connectors serving movable appliances.

This box is not suitable for use with black iron pipe or any CSST brand other than TracPipe®CounterStrike®.

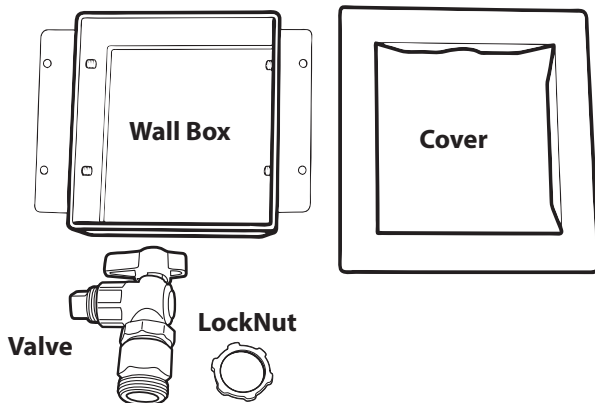

INSTALLATION INSTRUCTIONS:

1. Remove Knockout for appropriate size valve. The 3/8" and 1/2" size use the small knockout and the 3/4" size uses the the large knockout. Install TracPipe CounterStrike gas piping and cut to the desired length, using a standard tubing cutter with a sharp wheel. Using the strip length in the chart above, strip the jacket back and inspect the pipe for a clean cut without tears.

continued on back...

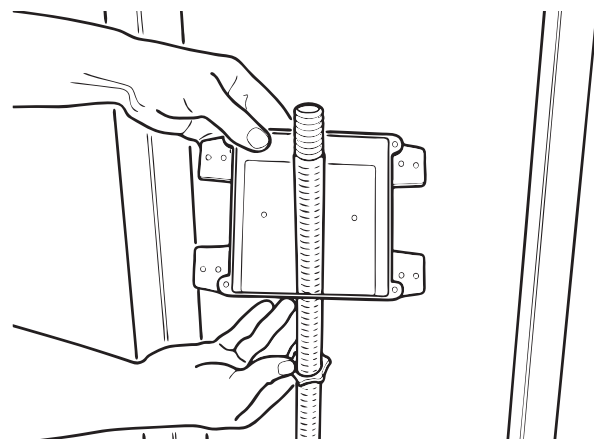

NOTE: These instructions are only a condensed version of the installation and must be used in conjunction with the TracPipe®CounterStrike® Design Guide & Installation Instructions. TracPipe®CounterStrike® flexible gas piping material must only be installed by a qualified person who has been trained through the TracPipe®CounterStrike® Gas Piping Installation Program.

NOTE: Mounting tabs are oriented for a single layer of drywall. When two layers are used for some 2 hr rated walls, remove screws on tabs and invert mounting tabs.

2. Remove the box cover and slip the locknut over the end of the pipe.
3. Disassemble the nut and split rings from the valve.

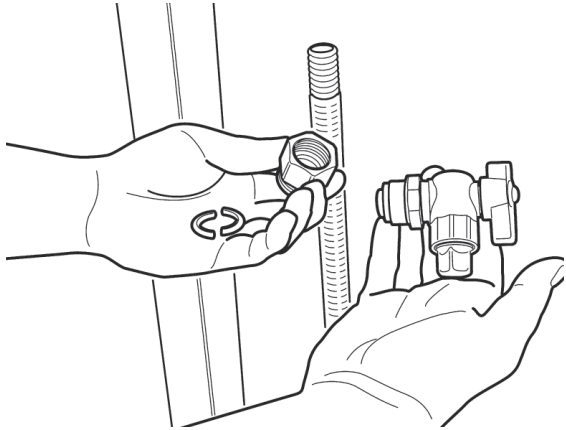

4. Slip nut over end of pipe and insert split rings into the valley of the first corrugation.

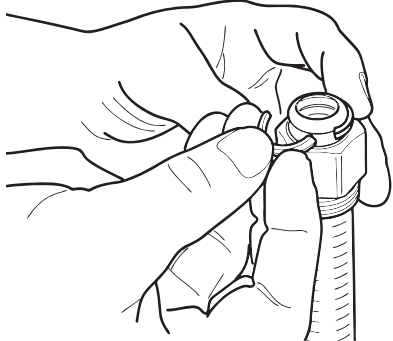

5. Thread ball valve onto nut and tighten so valve outlet faces forward. It is recommended that crescent wrenches be used to avoid damaging valve or nut. **Do not use thread sealants on this connection.**

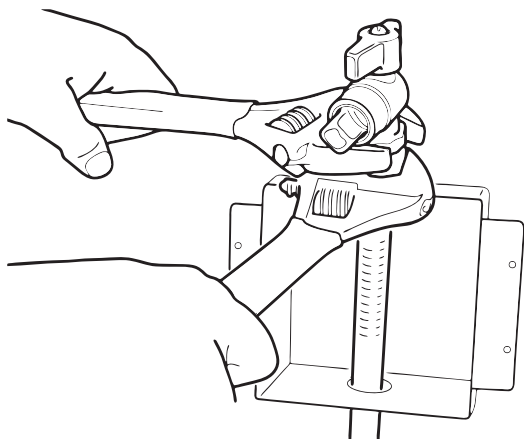

6. Slide box up and over the threads on the bottom of the nut and mount box firmly to stud. **Provide full support by fastening both mounting tabs to structure where required by local codes.**

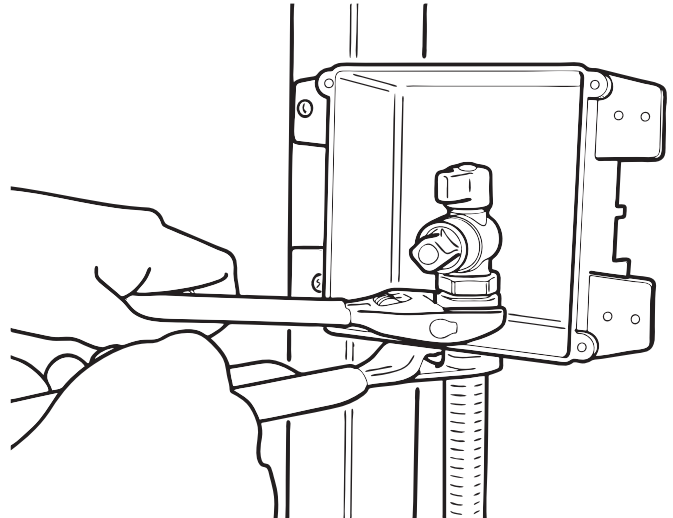

7. Secure valve assembly to box with locknut.

8. Install box cover after completion of drywall. If the gap between the edges of the box and the drywall is less than 1/4", no fire caulking is required.

See tracpipe.com for more information.

